

Soils Map

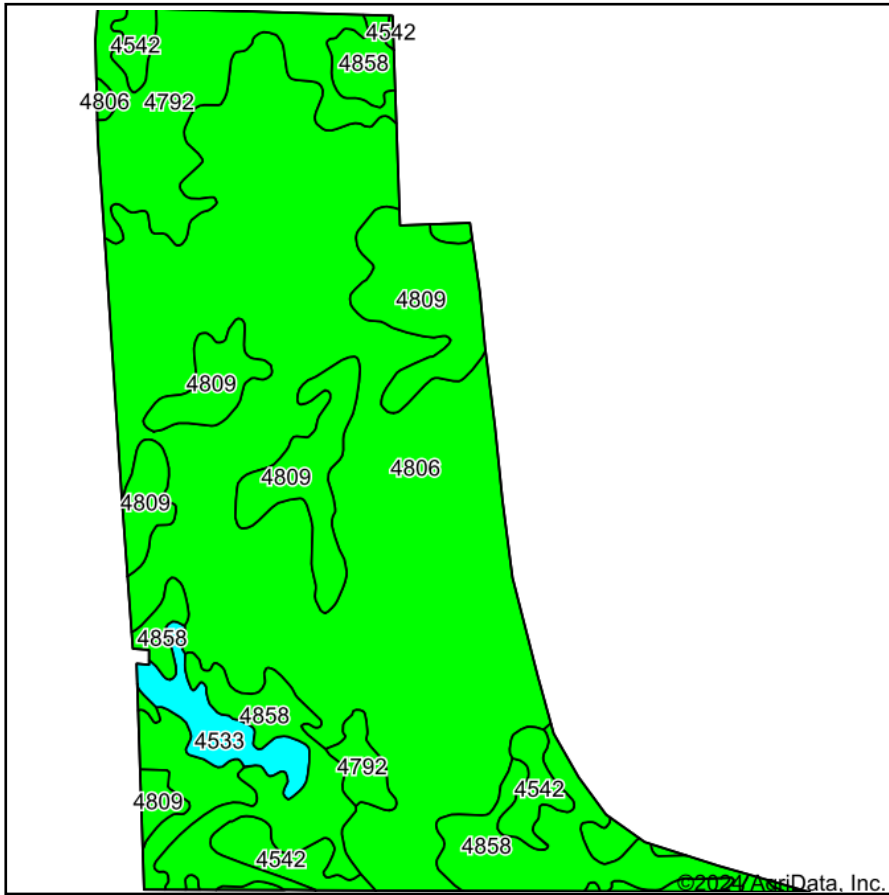

Soils data provided by USDA and NRCS.

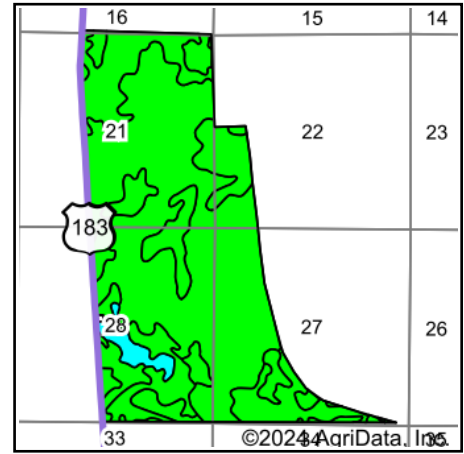

State: **Nebraska**
 County: **Rock**
 Location: **22-28N-19W**
 Township: **Selden**
 Acres: **1103.6**
 Date: **12/2/2024**



Maps Provided By:



© AgriData, Inc. 2023

www.AgriDataInc.com



Area Symbol: NE149, Soil Area Version: 24

Code	Soil Description	Acres	Percent of field	Non-Irr Class Legend	Non-Irr Class *c	Irr Class *c	SRPG	Alfalfa hay Irrigated Tons	Alfalfa hay Tons	Corn Irrigated Bu	Grain sorghum Irrigated Bu	*n NCCPI Overall	*n NCCPI Corn	*n NCCPI Soybeans
4806	Valentine fine sand, rolling, 9 to 24 percent slopes, moist	659.37	59.8%		Vle							23	21	16
4858	Valentine-Els complex, moist, 0 to 9 percent slopes	141.53	12.8%		Vle	IVe		3	1	80	20	28	26	20
4809	Valentine fine sand, rolling and hilly, 9 to 60 percent slopes, moist	129.22	11.7%		Vle							19	17	12
4792	Valentine fine sand, 3 to 9 percent slopes, moist	105.74	9.6%		Vle	IVe		3	1	81		31	30	22
4542	Els-lpage complex, 0 to 3 percent slopes	40.76	3.7%		VIw	IVw	26	2		51	39	25	18	18
4533	Els loamy sand, 0 to 3 percent slopes	26.98	2.4%		IVw		27					29	17	18
Weighted Average					5.95	*-	1.6	0.7	0.2	19.9	4	*n 24.2	*n 21.8	*n 16.7

Soils data provided by USDA and NRCS.

Maps Provided By:



© AgriData, Inc. 2023

www.AgriDataInc.com

*n: The aggregation method is "Weighted Average using all components"

*c: Using Capabilities Class Dominant Condition Aggregation Method

*- Irr Class weighted average cannot be calculated on the current soils data due to missing data.